

IMPORTANT! SAVE THE INSTRUCTIONS IN CASE YOU NEED THEM IN THE FUTURE! BEFORE ASSEMBLY AND USE CAREFULLY READ THE INSTRUCTIONS!

Thank you for your trust for purchasing this product – the folding Chair Nest.

On the back side of these instructions for use there are pictures that depict the assembly.

PACKAGE CONTENTS:

You should receive one box with the product. Please check that it contains all the parts listed below. If anything is missing, contact the manufacturer!

- 1 folding children's Chair Nest
- 1 instructions for use – a label to be put above/next to the Chair Nest
- 1 label for the door of the room where the Chair Nest is placed
- 1 set of screws for fastening
- 1 template for drilling holes for Chair Nest (ratio 1:1, on A3 paper)
- 1 instructions for use, assembly, maintenance and warranty
- 1 two (2) warning labels, that you need to stick on Chair Nest (based on enclosed instructions)

DIMENSIONS AND TECHNICAL DATA:

- Folded Chair: 530 mm x 590 mm x 30 mm, when open: 530 mm x 590 mm x 266 mm.
- Chair Nest weight: 6,00 kg
- The Chair Nest is made of high quality beech wood, which gives the product the requested safety and firmness.
- The Chair Nest is surface-treated with child-friendly colours and varnishes.
- The Chair Nest meets the safety standard EN 14988:2017 (E).

**WARNING!**

- **WARNING Never leave a child unsupervised.**
- **Danger of falling: Prevent children from climbing on the product.**
- **Do not use the product if all parts are not suitable placed and fastened.**
- **Do not use open fire or other sources of extreme heat near the product.**
- If the product is used for public purposes, place the label with instructions for use on a visible place directly next to it.
- Do not use accessories or spare parts that are not sold by the manufacturer of the product.
- Put the product away from shelves, wardrobes,..., to prevent injuries due to falling or access to dangerous objects.
- Do not use the product or prevent its use if all components are not placed or appropriately set.
- Prevent product use if it is damaged in any way or if any part is missing.
- The product cannot be used as a ladder, so do not step on it.
- Place the product on vertical surfaces of sufficient load capacity.
- To reduce the risk of injuries place or set the product away from furniture, walls, hot surfaces, liquids, windows, ropes and electric cables.
- Make sure that all users know how to handle it – be sure to place instructions for use directly next to it in public places.

- Be careful not to place the product near a heat source, for example, gas cooker, grill and such ...
- Do not use the product until the child is unable to sit alone without assistance.
- Your child's safety is your responsibility.
- Keep the package away from children to prevent the risk of suffocation.

CARE AND MAINTENANCE:

To keep the Chair Nest in excellent condition, note the following:

- Used materials are in compliance with the highest standards of resistance to sun rays. Despite that, the wooden parts can change their colour tone. Direct exposure to sun light will accelerate this natural process. This is not an error.
- To ensure the longer lasting of your Chair Nest and its accessories, clean it regularly and do not expose it to direct sun light
- Regularly check the Chair Nest and make sure all parts are in good condition.
- Contact the seller if any parts need to be fixed or replaced.
- Do not use the Chair if any part is bent, broken, or worn, until these parts are not replaced or fixed.

CLEANING:

- Do not use rough cleaning fluids or products for bleaching.
- Not suitable for washing under running water.

WARRANTY:

This product is in compliance with the applicable safety requirements. If any problems occur during normal use within the warranty period, contact the manufacturer.

Warranty conditions:

The warranty is valid for 12 months after the day of purchase. This warranty period cannot be extended, even if the product needs to be repaired. For a valid warranty, you must:

- Submit the original invoice to the seller.
- Submit a detailed description of the error to the seller.
- The warranty is valid only for the first owner of the product and cannot be transferred to subsequent owners.
- The warranty gives the owner the right to get the product repaired or replaced. If the repair is not possible, the manufacturer will refund the owner.

The warranty is not valid under the following conditions:

- The product was changed or repaired by a third party not authorised by the manufacturer.
- The error was made due to improper use or maintenance.
- The error is a result of an accident or damage by the delivery service.
- Normal wear is expected and is not an error or a warranty issue.



INSTALLATION HOTLINE:

00 386 31 515 343

INSTALLATION VIDEO:



INSTRUCTIONS FOR INSTALLATION:

! In any case, the product must be tightened to a firm and stable vertical surface! Glue can be used if necessary, but it is not obligatory. The glue itself is not enough!

! Place the Chair Nest on a vertical surface, check its firmness before use. The screws for tightening the Chair on the vertical surface must be tightened with the momentum of 5Nm!

! Installation and use of the product at your own risk!

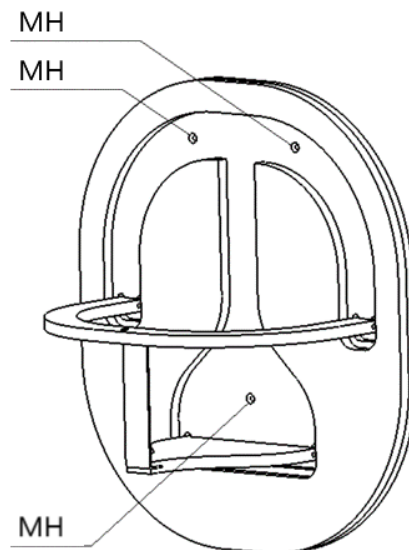
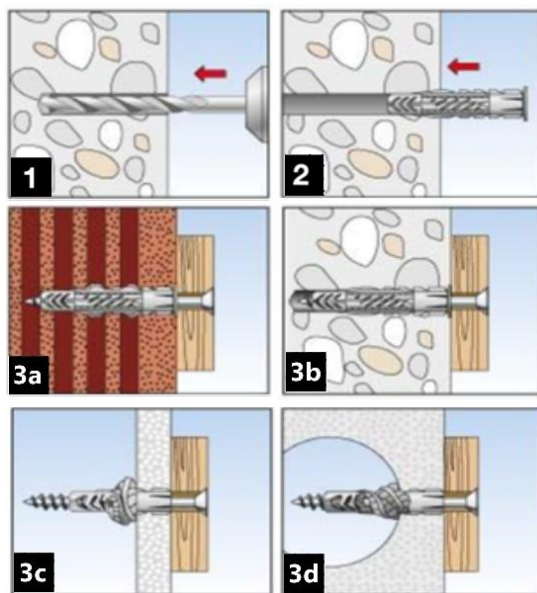

Figure 1 (MH – holes for screws, bolts)

OPTION 1 – Installation using plastic wall inserts



1	Using a suitable drill, drill a hole 8mm in diameter and 60mm in depth.
2	Put plastic inserts Z1 in the holes.
3a	Example of installation on a brick wall: Tighten the Chair Nest through the pre-drilled holes MH (figure 1) with screws Z2.
3b	Example of installation on a concrete wall: Tighten the Chair Nest through the pre-drilled holes MH (figure 1) with screws Z2.
3c	Example of installation on a gypsum-cardboard wall: Tighten the Chair Nest through the pre-drilled holes MH (figure 1) with screws Z2.
3d	Example of installation on bricks of light concrete: Tighten the Chair Nest through the pre-drilled holes MH (figure 1) with screws Z2.

OPTION 2 – installation using metric thread inserts for wood

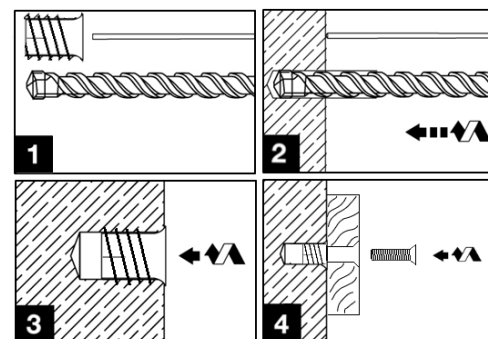

1	You need a drill for wood, 8mm in diameter and inserts Z3 for installation into particle boards at least 18mm in thickness.
2	Drill holes 15mm in depth. Slightly ream the hole with a reamer.
3	Put an insert for particle boards Z3 into a hole 8x15mm.
4	Tighten the Chair Nest onto a wall with the supplied screws Z4 through the holes MH (figure 1).

OPTION 3 – installation using self-tapping screws

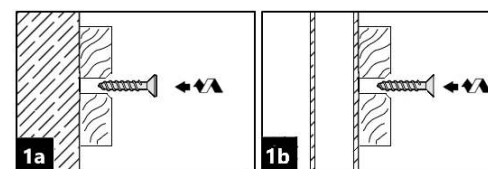

1a	Tighten the Chair Nest onto a wooden wall with the supplied screws Z5 through the holes MH (figure 1).
1b	Tighten the Chair Nest onto a hollow wooden or particle board wall with the supplied screws Z5 through the holes MH (figure 1). We recommend using glue (figure 2).

OPTION 4 – Installation using a screw connection

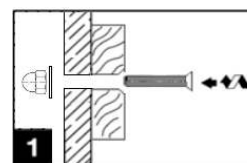

1	If you wish to tighten the Chair Nest onto a plastic wall, we recommend using a classic screw connection. Drill through the wall using an appropriate drill 6mm in diameter. Tighten the Chair Nest through the holes MH (figure 1) with the screw Z4, and place a washer Z6 and a top nut Z7 on the other side.
---	---------------------------------------------------------------------------------------------------------------------------------------------------------------------------------------------------------------------------------------------------------------------------------------------------------------------

Set of installation material and recommendation

Z1	3 pcs	Plastic insert fi8x50mm
Z2	3 pcs	Screw INOX 6x60mm
Z3	3 pcs	Insert for wood fi 8mm with screw internal thread M6
Z4	3 pcs	Screw M6x25mm
Z5	3 pcs	Screw 4.5x25mm
Z6	3 pcs	Washer M6
Z7	3 pcs	Top nut M6

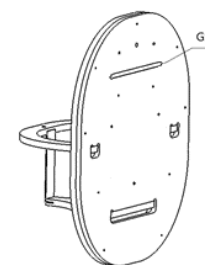

Figure 2

OUR RECOMMENDATION!

If you think that the surface is not firm enough (the screws do not provide enough load capacity for the Chair), we added a space (GS) for placing adhesive mass like Sikaflex Pro 3. We strongly advise against using only the adhesive for placing the Chair on a wall!